

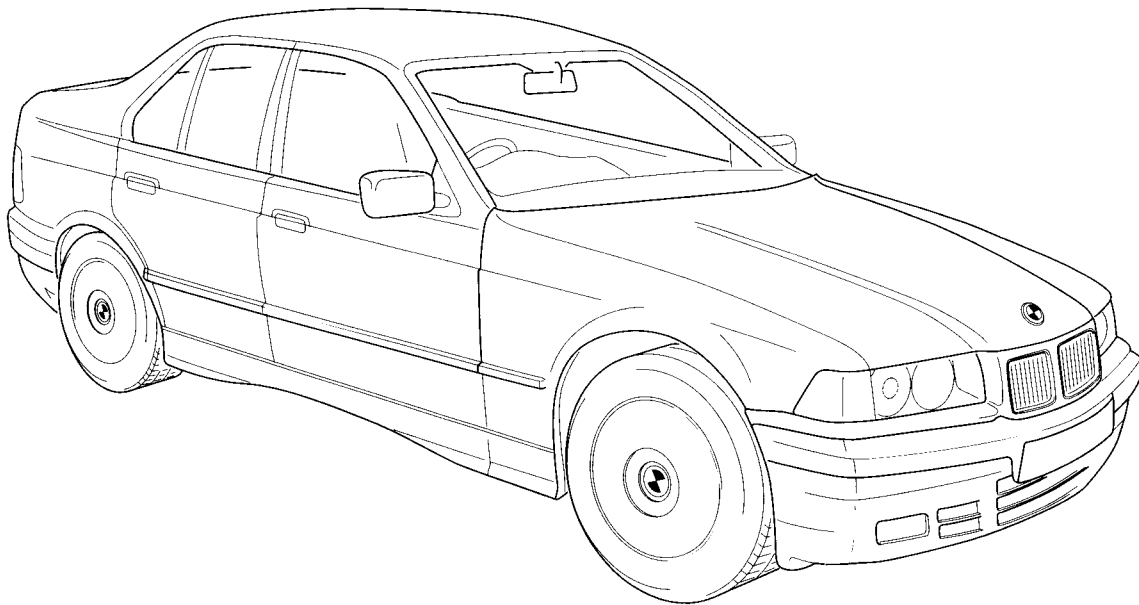

Parts and accessories Installation Instructions



F 36 82 918 R

**Digital Antitheft Alarm System 3G EWS
with override function
Right-Hand Drive
BMW 3 Series E36 (Coupé / Saloon / Compact / Convertible / Touring)**

(Only intended for use in BMW dealership network (HO))
Installation time for alarm system approx. 3 hours,
Knowledge of the vehicle electrical system is required

Notes on these installation instructions

The antitheft alarm system 3 G EWS can be installed on vehicles equipped with EWSII.

Tools and auxiliaries required

Phillips screwdriver	Screwdriver for slotted head screws
1/2 inch reversible ratchet	Hammer
1/2 inch socket wrench insert WAF 10 mm, 13 mm	Drill
1/2 inch extension	Side cutters
Twist drill Ø 3 mm, 3.5 mm, 6.5 mm, 8 mm	Centre punch
Ring spanner WAF 7 mm, 10 mm, 13 mm	Multiple slip-joint gripping pliers
Box spanner WAF 8 mm, 10 mm	Priming stick
Inspection lamp	General-purpose knife
Insulation stripping pliers	Multimeter
Cable pliers BMW No. 81 24 9 408 449	Water-soluble pen
Crimp pliers BMW on-board electrical kit I - IV	Press-out tool for 2.5 mm round contacts
Torx screwdriver T10	Insulation tape
Sealing compound (Silicon)	

Contents

Chapter

1. Necessary Preliminary work on Vehicle	2
2. Installation Overview of Components	3
3. Connection Overview of Alarm System Wiring Harness	4
4. Installing Siren	6
5. Installing Engine Compartment Contact Switch	6
6. Installing Ultrasonic Sensors	7
7. Installing Central Alarm Module	7
8. Installing Antenna	10
9. Electrical Connections in Passenger Footwell	10
10. Installing LED	12
11. Electrical Connections on Driver's Side	13
12. Function Check	14
13. Troubleshooting Table	14
14. Notes on Customer-Specific Programming	15
15. Schematic	16
16. Re-encoding Hand-Held Transmitters with Change Code	18

1. Necessary Preliminary work on Vehicle

- Print out defect code memories of various control units.
- Disconnect vehicle battery.
- Remove bottom left dashboard trim.
- Remove cover under glovebox.
- Remove glovebox.
- Remove A-pillar trim.
- Models with control unit support bracket:
 - Remove control unit support bracket under glovebox area.
- Release ABS control unit.
- Remove sill strips (rocker panels) on driver's side.
- Remove rear bench seat.

2. Installation Overview of Components

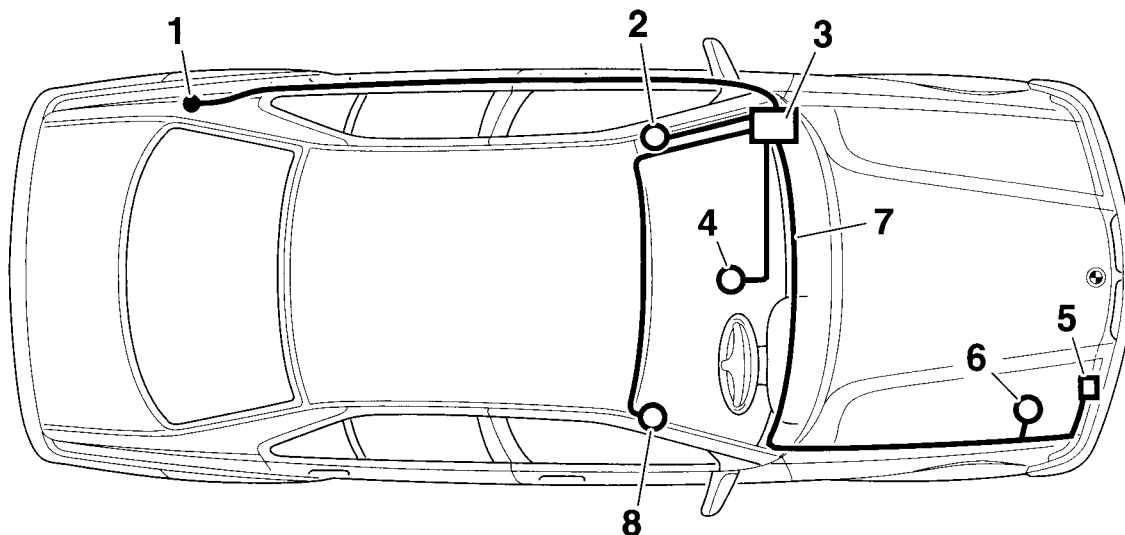

F 36 82 623 R

Key

1. Luggage compartment connection
2. Ultrasonic sensor at top of left-hand A-pillar
3. Central alarm module in area of glovebox
4. LED in oddments tray of centre console
5. Engine compartment contact switch in area of RH light cluster
6. Siren, on RH frame side member under wash water reservoir
7. Ultrasonic sensor at top of right-hand A-pillar
8. Alarm system wiring harness

Note

Insulate all wires not required and tie back.

Deburr any holes which may be necessary in the body and coat with zinc paint to protect from corrosion.

Seal cable leadthroughs to engine compartment with suitable sealing compound.

Caution

Use the AMP connectors provided in the installation kit for making all electrical connections.

Cut through wires and crimp on the AMP connectors.

Caution

In the course of continuous updating of the electrical systems of individual models, it is possible that connector designations (X designation) and/or wire colours may change. For these reasons, when installing an alarm system, always ensure you have the latest edition of the inspection manual.

3. Connection Overview of Alarm System Wiring Harness

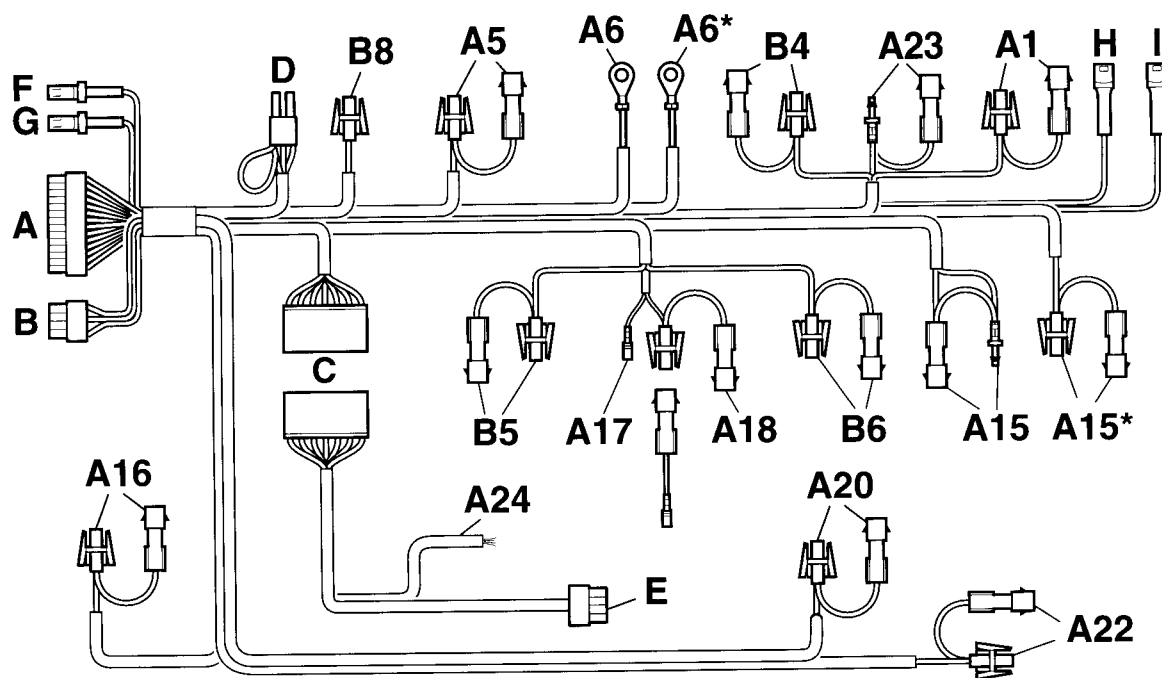

F 36 82 624 R

Item	Designation	Wire colour	Connection location in vehicle
A	White 24-pin connector	—	Central alarm module
A1	Branch, door contact switch, driver's side	brown/grey	<p>Only models without central locking (ZV) Wiring harness for interior lighting/door contact switch in glovebox area (brown/black wire)</p> <p>Only models with central locking (ZV) module ZV module A30, white, 26-pin connector X13012, plug-in slot No. 4 (brown/grey/yellow wire)</p> <p>Only models from 9/93 with general module (ZKE) Behind glovebox, general module A104, green 26-pin connector X13254, plug-in slot No. 2 (brown/grey/yellow wire)</p>
A5	Branch, terminal R	violet/white	<p>Only models without central locking (ZV) At lower right of steering column, black 12-pin connector X33, plug-in slot No. 2 (violet wire) (Make wire and extend alarm system wiring harness)</p> <p>Only models with central locking (ZV) module ZV module A30, white 26-pin connector X13012, plug-in slot No. 7 (violet/white wire)</p> <p>Only models from 09/93 with general module (ZKE) Behind glovebox, comb connector X1235 (violet/white wire) or 6-pin black connector X322, pin 2 (violet/white wire) in left footwell.</p>
A6	Branch, ground	brown	Ground terminal point X1166 in passenger footwell under carpet
A6*	Branch, ground	brown	Ground terminal point X173 on instrument panel carrier, driver's side
A15	Branch, terminal 30	red	<p>Only models without central locking (ZV) Wiring harness for interior lighting/door contact switch in glovebox area (red/white wire)</p> <p>Only models with central locking (ZV) module ZV module A30, black 5-pin connector X13013, plug-in slot No. 2 (red/green/yellow wire)</p>

Item	Designation	Wire colour	Connection location in vehicle
A15	Branch, terminal 30	red	Only models from 09/93 with general module (ZKE) Behind glovebox, general module A104, black 15-pin connector X13252, plug-in slot No. 10 (red/green/yellow wire)
A15*	Branch, terminal 30	red	Comb connector X1079, red/white wire in comb connector box, driver's side under instrument panel
A16	Branch, hazard warning lights	blue/red	Hazard warning light switch, black 5-pin connector X516, plug-in slot No. 2 (brown/blue wire)
A17	Branch, central locking system (central arrest)	yellow/blue	Only models with central locking (ZV) module ZV module A30, white 26-pin connector X13012, plug-in slot No. 24 Only models from 09/93 with general module (ZKE) Behind glovebox, general module A104, yellow 26-pin connector X13253, plug-in slot No. 17 (white/red/yellow wire)
A18	Branch, central locking system (open)	green/blue	Only models with central locking (ZV) module ZV module A30, white 26-pin connector X13012, plug-in slot No. 25 Only models from 09/93 with general module (ZKE) Behind glovebox, general module A104, yellow 26-pin connector X13253, plug-in slot No. 4 (blue/red/yellow wire)
A20	Branch, terminal 61	blue/white	Models without blue 30-pin SA connector X1020B Comb connector X213 on driver's side, at top below dashboard (blue wire) Models with blue 30-pin SA connector X1020B SA connector plug-in slot No. 3 (blue wire)
A22	Branch, luggage compartment switch	brown/white	Luggage compartment switch in rear lid or below cover in luggage compartment, rear left (brown/white wire)
A23	Branch, rear door contact switch (4-door models only)	brown/black	Only models with central locking (ZV) module ZV module A30, black 4-pin connector X13014, plug-in slot No. 2 (brown/black wire) Only models from 09/93 with general module (ZKE) Behind glovebox, general module A104, green 26-pin connector X13254, plug-in slot No. 4 (rear door contact, driver's side) and plug-in slot No. 5 (rear door contact passenger's side) (brown/white wire)
A24	Branch, engine compartment contact switch	black	Engine compartment contact switch in area of right-hand light cluster.
B	White 8-pin connector	—	Central alarm module
B4	Branch, door contact switch, passenger's side	brown/blue	Only models without central locking (ZV) Branch is not connected Only models with central locking (ZV) module ZV module A30, white 26-pin connector X13012, plug-in slot No. 2 (brown/blue/yellow wire) Only models from 09/93 with general module (ZKE) Behind glovebox, general module A104, green 26-pin connector X13254, plug-in slot No. 3 (brown/blue/yellow wire)
B5	Branch, central locking (synchronisation for opening)	white/green	Only models with central locking (ZV) module ZV module A30, white 26-pin connector X13012, plug-in slot No. 18 (white/green wire) Only models from 09/93 with general module (ZKE) Behind glovebox, general module A104, yellow 26-pin connector X13253, plug-in slot No. 1 (white/green wire)
B6	Branch	white/black	Not required
C	Black 6-pin connector	—	Siren wiring harness
D	White 4-pin connector	—	LED wiring harness
E	White 8-pin connector	—	At emergency current siren in front engine compartment, driver's side
F	Branch ultrasonic sensor	black with red indication	Central alarm module in rear left seat box, right plug-in slot on outside of connection side of central alarm module

G	Branch ultrasonic sensor	black with white identification	Central alarm module in rear left seat box, right plug-in slot on inside of connection side of central alarm module
H	Branch ultrasonic sensor	black with red identification	Ultrasonic sensor wiring harness
I	Branch ultrasonic sensor	black with white identification	Ultrasonic sensor wiring harness

4. Installing Siren

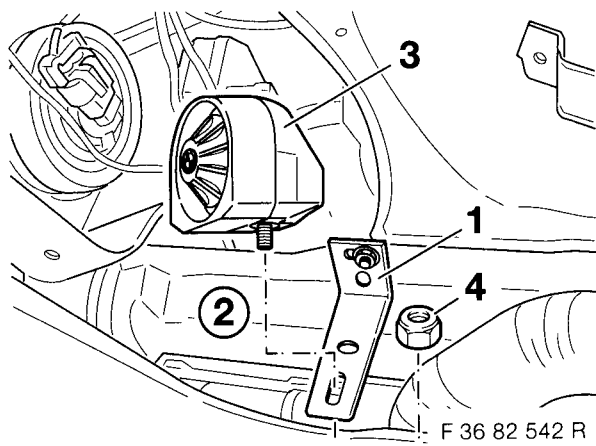

Secure support bracket (1) as illustrated with hexagon screw M6 x 12, washer and hexagon lock nut M6 at the square hole provided in side member (2). Secure siren (3) with lock nut M6 on support bracket (1).

If there is any deviation from the proposed installation location for the siren, select a location

- which does not impair the engine cooling system and does not obstruct the front lid from closing.
- such that the integrated emergency lock is accessible.
- such that a minimum distance of 300 mm is maintained to the outer edges of the vehicle.

Connect siren wiring harness to siren (branch E), route wiring harness under wash water reservoir to main vehicle wiring harness.

Route siren wiring harness along main vehicle wiring harness to leadthrough grommet under brake booster.

5. Installing Engine Compartment Contact Switch

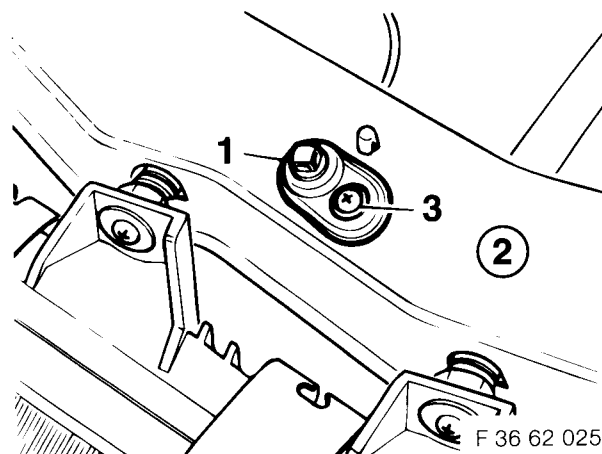

Insert engine compartment contact switch (1) in the hole provided in the body in the area (2) of the right-hand light cluster and secure with Phillips screw (3).

Caution

Models with standard engine compartment contact switch

Remove engine compartment contact switch and install contact switch from installation kit with two connection terminals.

A24 Route branch for engine compartment contact switch, black wire, along main vehicle wiring harness to engine compartment contact switch and connect.

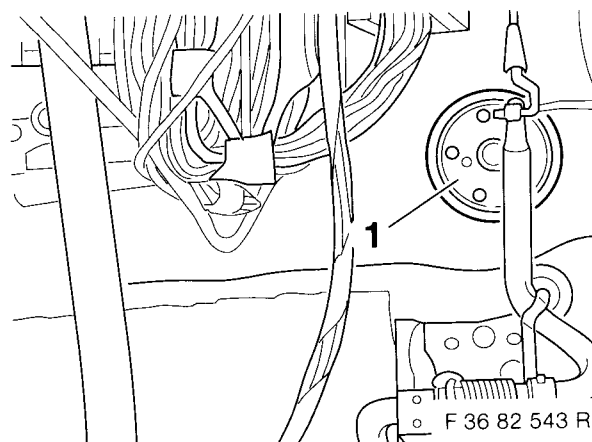

Press leadthrough grommet (1) into inner of vehicle. Cut out prestamped point in grommet (1) and pull through siren wiring harness.

6. Installing Ultrasonic Sensors

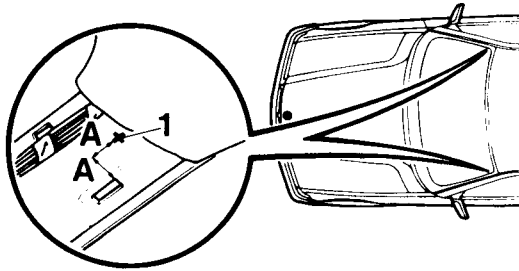

F 36 62 009

Left and right A-pillar

Measure out drilling point (1), mark and centre punch.

A = 10 mm

Caution

Hole diameter 3 mm.

Drill through drilling point (1), deburr and apply primer.

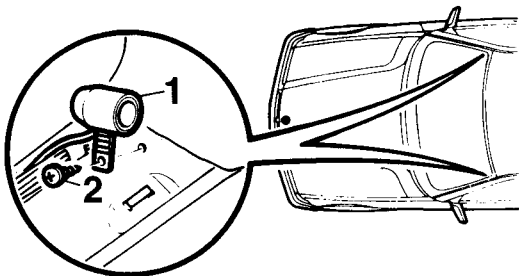

F 36 62 080

Caution

The wires of the ultrasonic sensors are identified by colours (colour coded).

White colour code = A-pillar on passenger side

Red colour code = A-pillar on driver side

Secure ultrasonic sensor (1) on corresponding A-pillar with Phillips screw (2).

Route ultrasonic sensor wire from driver's side under vehicle headliner to passenger's side.

7. Installing Central Alarm Module

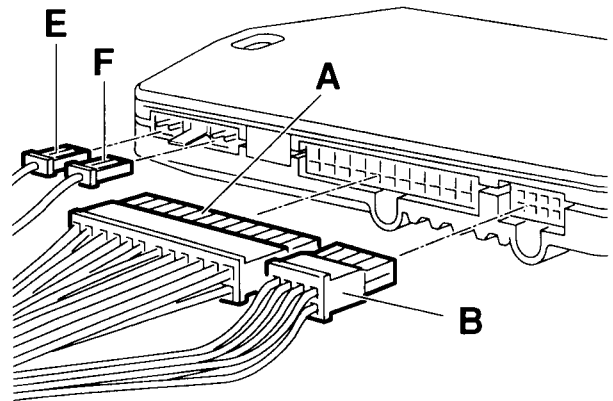

F 34 62 222

Caution

Plug in connector E (red) on outer right hand side. Plug in connector F (white) on inner right hand side.

Jumper (1) must be connected between connector E and F otherwise the interior monitoring facility will not function.

Plug connectors (A, B, E and F) into central alarm module.

All models apart from E36 Compact

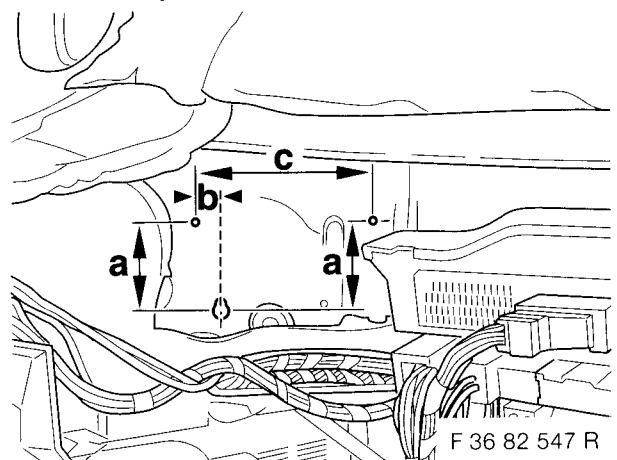

F 36 82 547 R

Remove soundproofing as illustrated. Mark holes (1) and (2) and drill out in body with angle drill and 3 mm twist drill.

Dimensions:

- a = 50 mm
- b = 40 mm
- c = 155 mm

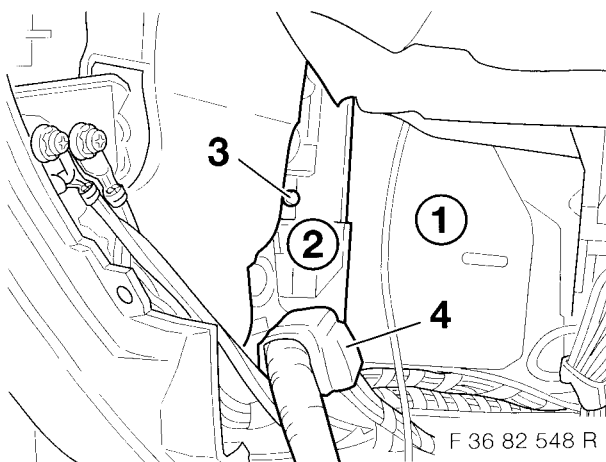

Fit cover (1) on central DWA module (2) and secure to body with special screws (3) from the installation kit. route alarm system wiring harness (4) into passenger footwell.

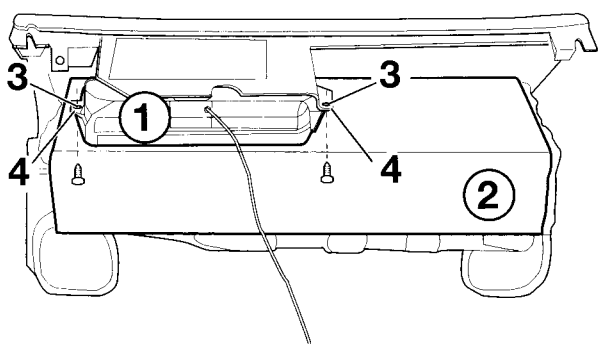

F 36 82 583

Attention

This installation is only necessary, if the car is equipped with an additional sound system. Place control unit (1) on the glove compartment (2) as shown and fix with insulating tape. Insert the glove compartment provisionally. Check that the control unit does not touch anywhere (airvent for passenger footwell). Otherwise re-adjust control unit. Connect all plugs to control unit as described in F 34 62 222

Attention

Use a drill with depth gauge.

Mark out bore points (3) and drill with the twist drill 5,5 mm.

Mount the metal nuts on the foils (4) of the control unit (1).

Fix the control unit from the inside to the glove compartment with the metal screws supplied in the installation kit.

E36 Compact without passenger airback

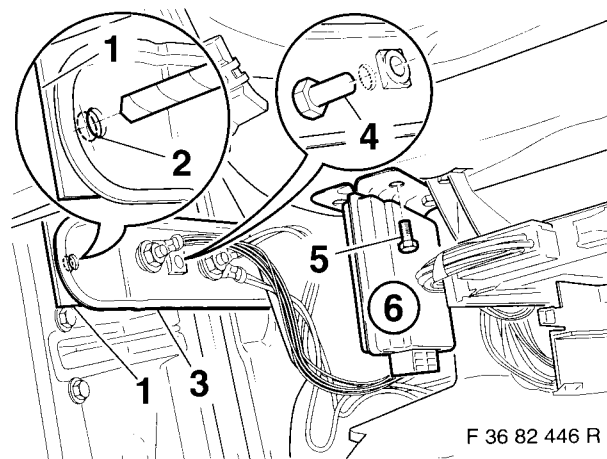

Drill through plastic tab (1) with 6.5 mm twist drill through the existing hole (2) in dashboard carrier (3). Remove hexagon screw (4). Remove hexagon screw (5) at ABS control unit (6).

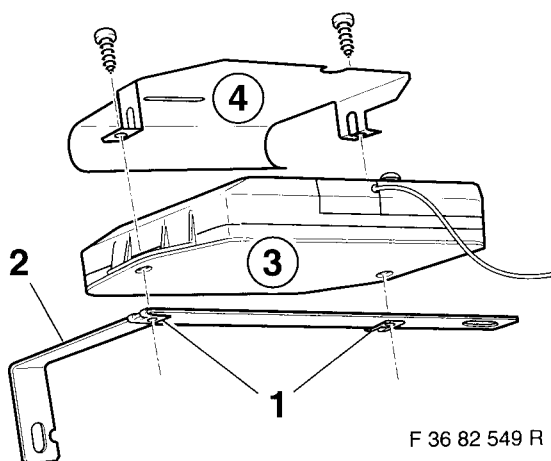

F 36 82 549 R

Fit speed nuts (1) as illustrated on support bracket (2) (Part No. 82 91 9 404 688).

Fit cover (4) on central alarm module (3) and secure to support bracket (2) with retaining screws (5).

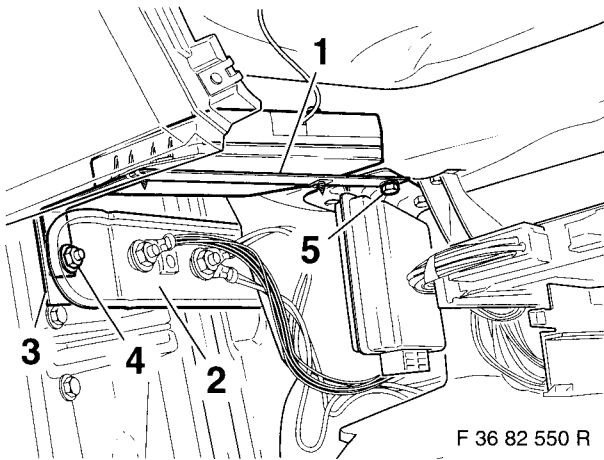

Fit support bracket (1) as illustrated between dashboard carrier (2) and plastic tab (3) of dashboard.

Note

The recess on support bracket must be fitted in centring pin of dashboard carrier.

Secure support bracket with hexagon screw M6x16 (4), washer, spring washer and hexagon nut M6. Secure other end of support bracket together with ABS control unit and with hexagon nut (5) at top of dashboard.

Reinstall dashboard retaining screw.

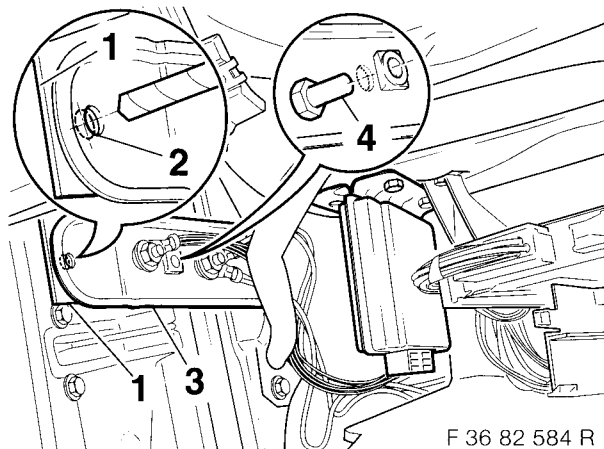

Drill the plastic panel (1) with twist drill diam. 6.5 mm through the existing hole (2) on the instrument panel (3). Remove the hexagon screw (4).

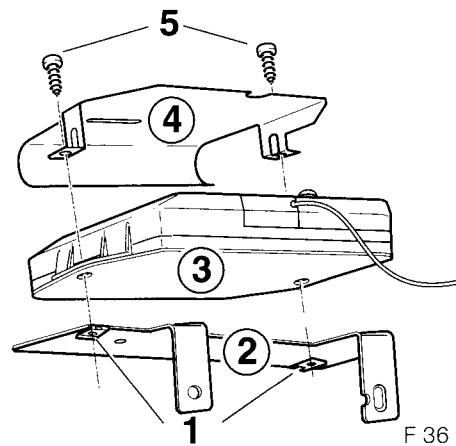

Illustration shows System IIIG

Place the metal nuts (1) as shown on the bracket (2).

Connect the system 3G-wiring loom to the central alarm unit (see F 34 62 222). Put the Cover (4) on the control unit (3) and secure on the bracket (2) with the screws (5).

Notice

With System IIIG the safety screws in the installation kit must be used.

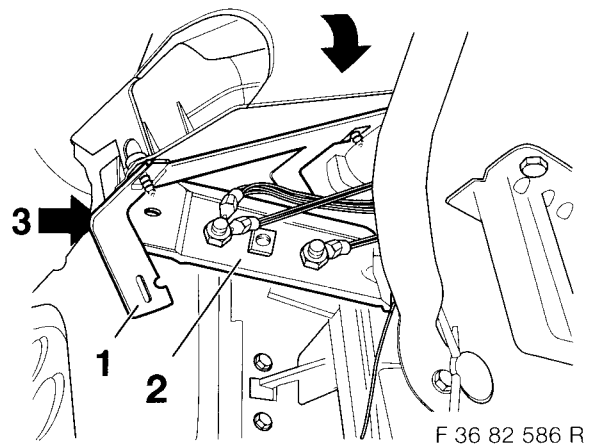

Incline in the direction of the arrow the system 3G EWS control unit with the bracket (1) as shown between the instrumental panel (2) and the plastic panel (3) and push into position.

8. Install Antenna

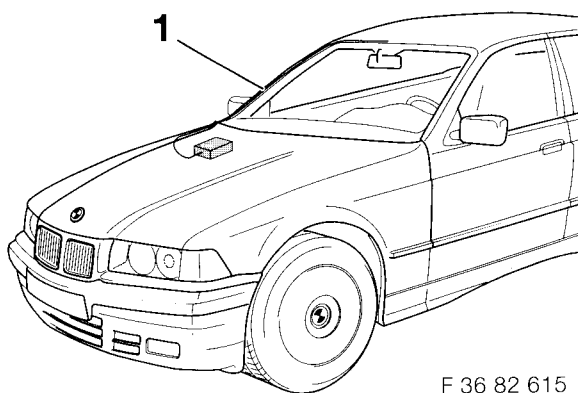

Only E36/2, 13 (touring), 14, 15 (compact)

Install antenna-wire (1) as shown behind the A-pillar trim cover up, beneath the roof covering.

Only E36/C (cabrio)

Install antenna-wire like above behind the top cover of the front-windowframe

Attention

Don't shorten or damage the antenna wire.
Avoid metal contact.

9. Electrical Connections in Passenger Footwell

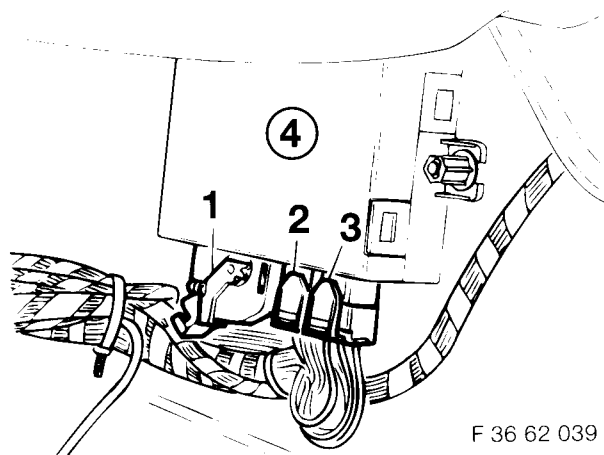

Only models with central locking (ZV) module

Unplug connectors (1, 2, 3) from ZV module A30 (4).

Note

Connector (1) white, 26-pin = X13012
Connector (2) black, 4-pin = X13014
Connector (3) black, 5-pin = X13013

Connection to plug connector (1), white 26-pin X13012

- A1** Connect branch, door contact switch, driver's side, brown/grey wire, to wire at plug-in slot No. 4, brown/grey/yellow wire.
- A5** Connect branch for terminal R, violet/white wire to plug-in slot No. 7, violet/white wire.
- A17** Connect branch for central locking system (central arrest), yellow/blue wire to wire at plug-in slot No. 24
- A18** Connect branch of central locking system (open), green/blue wire to plug-in slot No. 25.
- B4** Connect branch, door contact switch, passenger's side, brown/blue wire to plug-in slot No. 2, brown/blue/yellow wire.
- B5** connect branch for central locking system (opening synchronisation), white/green wire to plug-in slot No. 18, white/green wire.

Connection to plug connector (3), black 5-pin X13013

- A15** Connect branch for terminal 30, red wire to plug-in slot No. 2, red/green/yellow wire.

Connection to plug connector (2), black 4-pin X13014

- A23** Connect branch, rear door contact switch (4-door models only), brown/black wire to plug-in slot No. 2, brown/black wire.

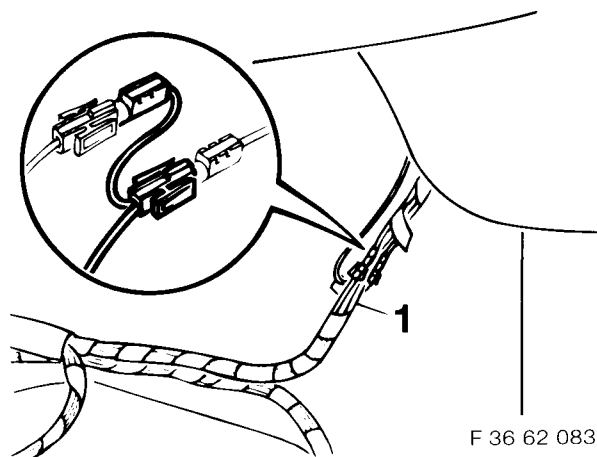

Only models without central locking ZV

- A1** Connect branch, door contact switch, driver's side, brown/grey wire to wiring harness for interior lighting/door contact switch (1), brown/black wire.
- A15** Connect branch for terminal 30, red wire to wiring harness for interior lighting/door contact switch (1), red/white wire.

Only models from 09/93 with general module (ZKE)

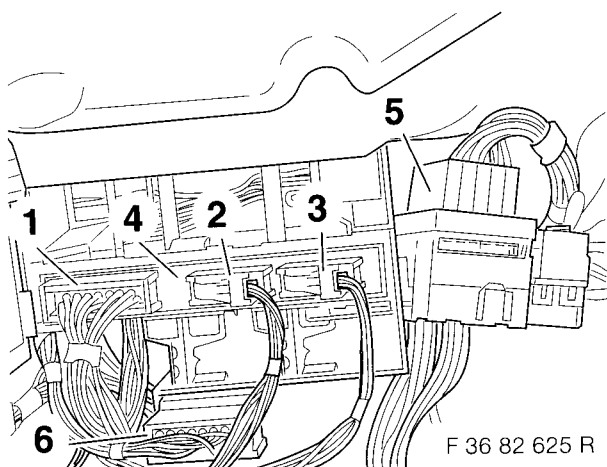

F 36 82 625 R

Note

- Connector (1) black, 15-pin = X13252
- Connector (2) yellow, 26-pin = X13253
- Connector (3) green, 26-pin = X13254
- General module (4) = A104
- Comb connector (5) = X1235

Connection to plug connector (1), black 15-pin X13252

- A15** Connect branch for terminal 30, red wire to plug-in slot No. 10, red/green/yellow wire.

Connection to plug connector (2), yellow 26-pin X13253

- A17** Connect branch for central locking system (lock), yellow/blue wire at plug-in slot No. 17, white/red/yellow wire or connect to white/red/yellow wire.
- A18** Connect branch for central locking (open), green/blue wire at plug-in slot No. 4, blue/red/yellow wire (adapter lead) or connect directly to blue/red/yellow wire.
- B5** Connect branch for central locking (opening synchronisation), white/green wire to plug-in slot No. 1, white/green wire.

Connection to plug connector (3), green 26-pin X13254

- A1** Connect branch, door contact switch, driver's side, brown/grey wire to plug-in slot No. 2, brown/grey/yellow wire.
- B4** Connect branch from door contact switch, passenger's side, brown/blue wire to plug-in slot No. 3, brown/blue/yellow wire.

Connection to comb connector (5) X1235

- A5** Connect branch for terminal R, violet/white wire to comb connector X1235 (5), violet/white wire, or connect to 6-pin black connector X322, under carpet, pin 2, violet/black wire.

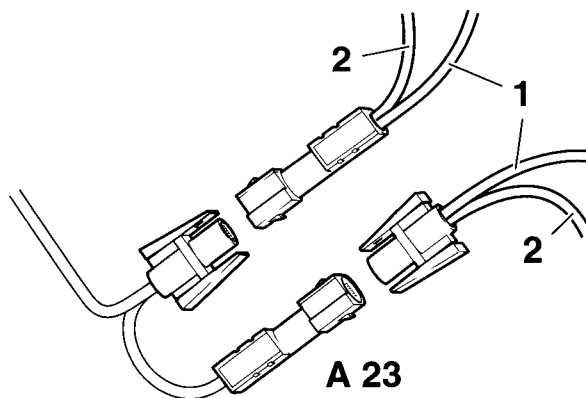

F 36 82 160

Only 4-door models

- A23** Cut open branch for rear door contact switch at plug-in slot No. 4, brown/black wire and strip insulation at both ends. Cut open brown/white wire at plug-in slot No. 5 and strip insulation at both ends. Crimp together wires (1) (plug-in slot No. 4 and (2) (plug-in slot No. 5) coming from connector using contact bushes. Fit bush housing. Crimp together wires (1) and (2) coming from standard wiring harness using pin contact. Fit pin housing. Connect branch for rear door contact switch (A23).

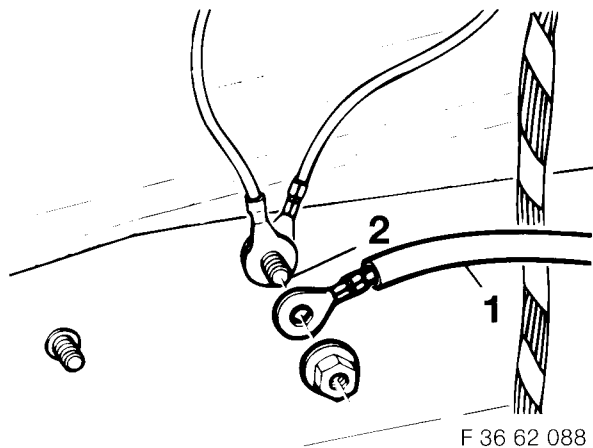

F 36 62 088

- A6** Connect ground branch (1), (brown wire) to ground terminal point X1166 under carpet on passenger side (2).

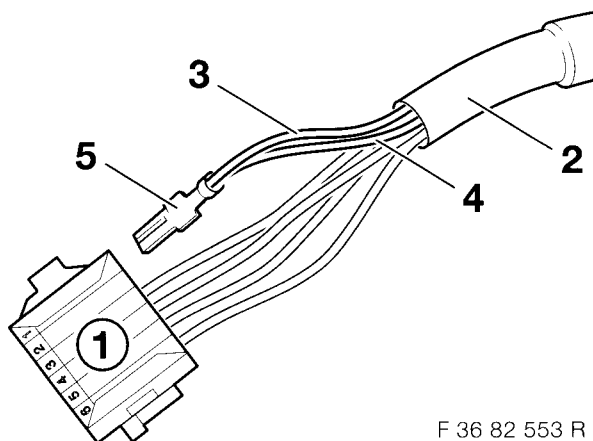

F 36 82 553 R

Crimp contacts (5) on siren wiring harness (2).
Crimp together brown wire (3) with brown/red wire (4).
Plug in wires as follows in 6-pin connector housing (1):

Plug-in slot No.	Wire colour
1	brown; brown/red
2	-
3	white/black
4	violet/grey
5	black
6	red

Plug together connector housing (1) with mating connector of alarm system wiring harness (branch E).

10. Installing LED

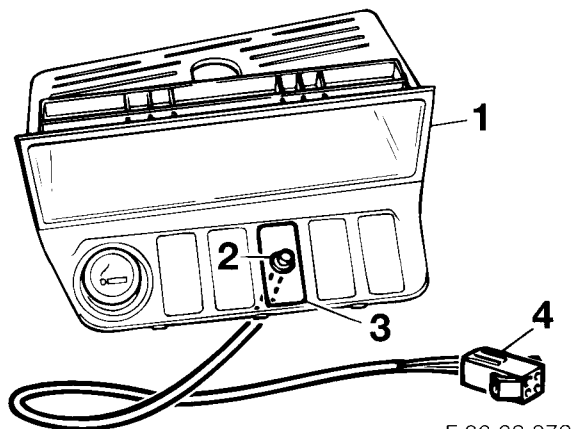

F 36 62 079

All E36 models except E36 Compact

Pry centre cover out of oddments tray insert (1) and insert LED (2) in cover (3).
Route LED wiring harness into passenger footwell.
Install cover (3) in oddments tray insert (1).
Plug in wires of same colour as connector D on alarm system wiring harness in housing (4). Join together housing and mating connector.

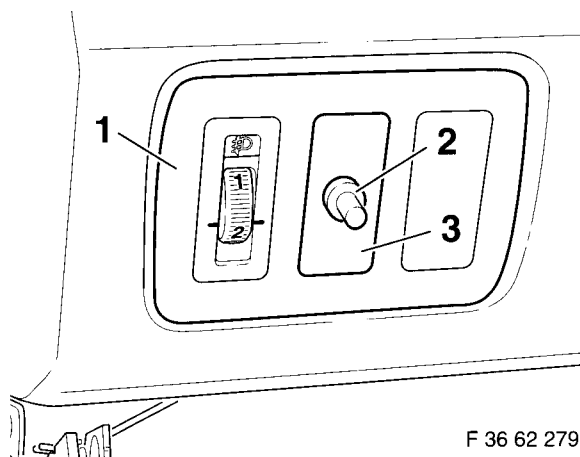

F 36 62 279

Only E36/5 (Compact)

Pry centre cover (3) out of switch carrier (1) and insert LED (2) in cover (3).
Route LED wiring harness on passenger side and connect same wire colours as branch D on alarm system wiring harness.

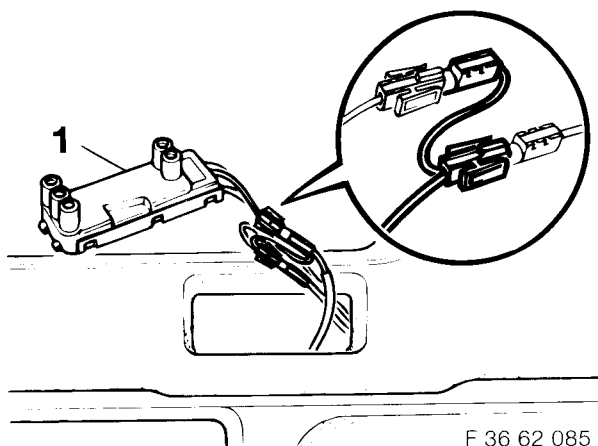

F 36 62 085

A16 Connect branch for hazard warning lights, blue/red wire to wire in connector X516 (1), plug-in slot No. 2, brown/blue wire.

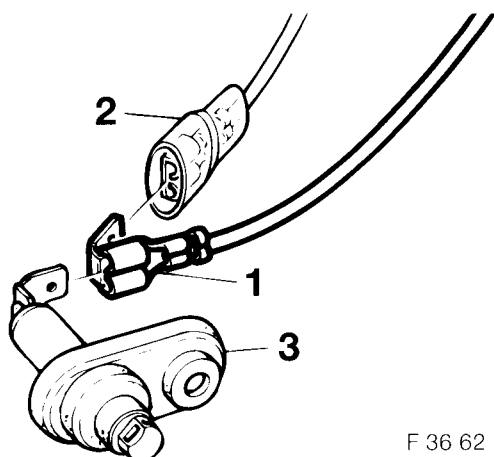

F 36 62 090

Only E36/2 (Coupé) and E36/4 (Saloon)

A22 Branch for luggage compartment switch. Remove cover in rear left luggage compartment. Locate brown/white wire and connect, or remove luggage compartment switch, crimp contact (1) to branch for luggage compartment switch, connect to standard wire (2) on luggage compartment switch and install luggage compartment switch.

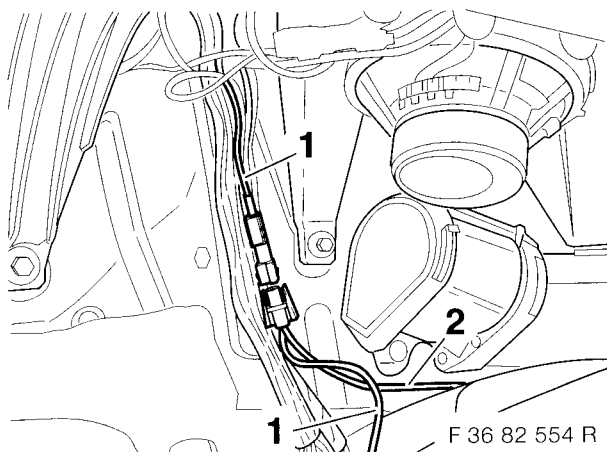

F 36 82 554 R

Only E36/5 (Compact)

A22 Route branch from luggage compartment switch, brown/white wire down left side of vehicle along vehicle wiring harness into luggage compartment. Locate wire (1) from wiring harness and cut through, connect branch **A22** to wire (1) as illustrated.

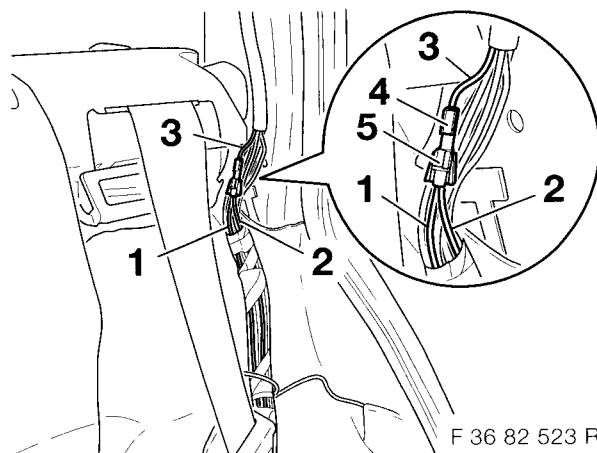

F 36 82 523 R

Only E36/3 (touring)

(Area of left rear seat backrest)

A22 Route branch luggage compartment switch (1), brown/white wire along vehicle wiring harness to left-hand back seat backrest. Cut through brown/white wire of vehicle wiring harness and strip insulation. Crimp together wires (1) and (2) with plug contact from the installation kit. Crimp plug contact onto wire (3). Fit connector housings (4) and (5) and connect together.

11. Electrical Connections on Driver's Side

Route branch **A6*** (brown wire) **A15*** (red wire) and **A20** (blue/white wire) of alarm system wiring harness along main vehicle wiring harness to driver's side.

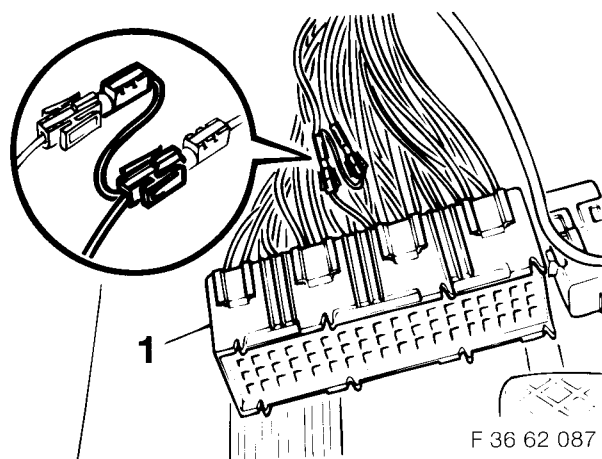

F 36 62 087

A15* Connect branch for terminal 30, red wire to red/white wire in comb connector X1079 of comb connector box (1).

A20 Connect branch for terminal 61, blue/white wire to blue wire in comb connector X213 of comb connector box (1).

13. Function Check

Note

DDWA III system cannot be armed if terminal R, terminal 15 or terminal 61 are active by ignition/starter switch.

Procedure	Feedback
1. Arm system 3G EWS with hand-held transmitter.	LED in hand-held transmitter must light brightly. Doors and luggage compartment are locked at the same time.
2. Hazard warning lights flash twice together with tone signal of emergency current siren.	All current circuits (door contacts, luggage compartment or engine compartment switch) connected correctly.
3. Hazard warning lights flash twice together with tone signal of emergency current siren followed by one 3 second long tone.	One or several current circuits (door contacts, luggage compartment or engine compartment switch) open or not connected.
4. After system 3G EWS LED lighting permanently for approx. 35 seconds in the centre console, it flashes at ration (1:1)	The arming phase is completed, the antitheft alarm system is activated.
5. Activate US sensors during 35 second arming phase with windows open by means of manual movement	LED in centre console lights distinctly brighter. Initial tone signal if emergency current siren installed.
6. Check emergency current siren a) by disconnecting battery b) by disconnecting siren wiring harness from DDWA 3G EWS wiring harness (6-pin black connector). Note: Alarm is stopped: By connecting battery or by connecting system 3G EWS wiring harness to siren wiring harness	Alternating tone signal because siren is equipped with batteries. (Alarm in the event of break in vehicle electrical system)

Caution

On vehicles equipped with an emergency lock, the siren can be switched off by setting the emergency lock to the "OFF" position.

14. Troubleshooting Table

Problem	Possible cause	Corrective measures
System 3G EWS cannot be armed	1. Hand-held transmitter/remote control 2. Positive connection terminal 30 to central alarm module 3. Ground connection to central alarm module	1. Replace battery for remote control, LED must light brightly when operating remote control 2. Measure voltage at system 3G EWS wiring harness branch A15. Replace fuse F35 if necessary. 3. Check DWA wiring harness branch A6 to body ground with ohmmeter. Specified value: 0 Ohm
Car check tone (tone signal after double confirmation tone while arming) sounds only on vehicles with emergency current siren	1. One door not closed 2. Rear lid open 3. Front lid open 4. Check programming (are door contacts switched negative?)	Check corresponding wire connections Carry out programming procedure
Battery constantly discharged LED of system 3G EWS does not emit light	Closed-circuit current too high LED defective	Maximum closed-circuit current of vehicle should be 25 mA. Check all connections. Check connections and supply wires of LED. Replace LED if necessary.

15. Notes on Customer-Specific Programming

Various functions such as volume of signal tone, checking alarm circuits during the arming phase, panic circuit etc. can be adapted to personal requirements.

The relevant settings are changed by way of programming with the corresponding programming unit.

Refer to the programming unit manual for more detail.

Volume of signal tone

Adjustable in 15 stages from OFF to max. volume.

Storage and indication of alarm triggering

LED indication of alarm triggering after disarming.

ON or OFF setting possible.

Vehicle check

Signal tone if alarm circuit not connected during arming phase.

ON or OFF setting possible.

Panic alarm

ON or OFF setting possible.

Slightly delayed opening and closing of central locking system when arming.

Self-arming

Optional self-arming of only multiple immobilizer (presetting) or of complete system including antitheft alarm system functions (passive 2)

If customer selects system 2, the system characteristics are changed considerably. See following function diagram:

Important:

These functions must be demonstrated and explained to the customer during vehicle hand-over because they are not included in the Owner's Handbook.

Functional diagram self-arming System 2

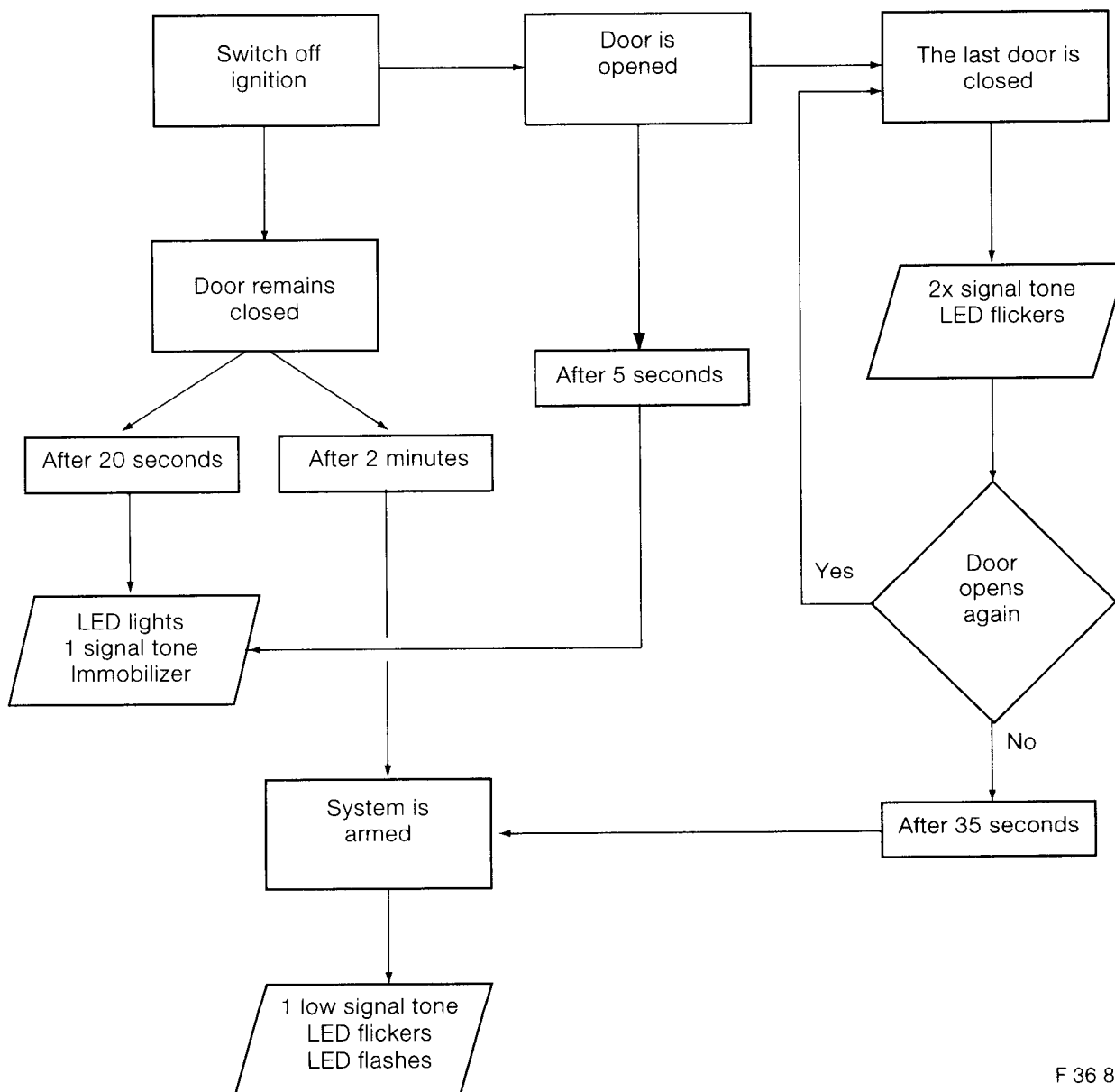

F 36 82 556 R

16. Schematic

Key

A 30/A 104	ZV module/general module ZKE	X1	Plug connector, 4-pin, LED DDWA III
H5	Siren for DDWA III	X2	Plug connector, 6-pin, siren/horn
		X161	Plug connector, 1-pin, white, near front right headlight
		X168	Plug connector, 1-pin, black, left steering column
		X351	Plug connector, 2-pin, black, in top of right B-pillar
		X352	Plug connector, 3-pin, black, in top of left B-pillar
		X516	Plug connector, 5-pin, black, centre console
		X711	Plug connector, 1-pin, natural, underside of left read lid
		X1239	Plug connector, 2-pin, black, right C-pillar
		X1240	Plug connector, 2-pin, natural, under LH side of rear seat

U1	Ultrasonic sensor, driver's side
U2	Ultrasonic sensor, passenger's side
V5	LED, DDWA III
Y	Multiple start interrupt module
Z	Central alarm module DDWA III

Connections A30/A104

N1	Opening synchronisation
N2	Central locking (ZV) - central arrest
N3	Central locking (ZV) - open

12. Re-encoding from Hand-Held Transmitters with Change Code

Each alarm system 3G EWS is capable of learning four different codes, i.e. if the original is lost, new hand-held transmitters can be programmed and used as a replacement.

Caution

All hand-held transmitters must be encoded in one operation.

BMW P/N hand-held transmitter	Country
82 92 9 402 531	Germany and export countries Without special regulations
82 92 9 402 876	CH, A, GB, NL
82 92 9 404 799	F

Carry out following steps in order to change the transmit codes (activation codes):

- a** Close driver's door and deactivate antitheft alarm system 3G EWS.
(Driver's door must be closed otherwise feedback to the central locking system is not possible.)

Caution

If no hand-held transmitter is available in order to deactivate the alarm system 3G EWS, the radio receiver (with hand-held transmitter) in cover of central alarm system 3G EWS module must be replaced.

- b** Remove rubber plug on upper side of central alarm system module and set slide switch to coding position.

Note

The slide switch can be set in two positions:

- Operating position (preset at factory)
- Coding position

Adjust slide switch with a small screwdriver for coding.

- c** Activate central alarm module with new hand-held transmitter by pressing the red ON button once.
- d** The central locking system is activated as a sign indicating the new code has been detected and stored correctly (the central locking system closes or opens depending on the initial status of the alarm system 3G EWS).

Note

To program another hand-held transmitter, follow the steps **c** and **d** with the new hand-held transmitter.

The other hand-held transmitters must be operated corresponding to the status of the central locking system after coding the first hand-held transmitter:

Example:

Alarm system 3G EWS deactivated and ground connection established:

Transmitter 1 activated with ON button.

Activate transmitter 2 with OFF button.

Activate transmitter 3 with ON button.

Activate transmitter 4 with OFF button.

Up to 4 hand-held transmitters can be used in this way.

- e** Reset coding switch back to its initial position.

Caution

If the coding switch is reset twice instead of once, the DWAll is reset and all stored codes will be lost. The programming procedure must be repeated from the beginning.

Finally re-install rubber plug in opening of control unit.

Note

Hand-held transmitters with fixed codes for earlier ALARM SYSTEM generations must still be ordered as before from BMW Sales Centres with specification of the code (82 11 9 401 529, 82 92 9 401 793, 82 92 9 401 801). However, they cannot be used for the system 3G EWS.

Wichtige Information!

Verwenden Sie zu Ihrer eigenen Sicherheit ausschließlich
Zubehörprodukte, die von BMW freigegeben sind.
Für von BMW nicht freigegebene Zubehörprodukte jedweder
Art übernimmt BMW keine Haftung.

**Weiteres BMW Zubehör,
um aus einem BMW Ihren BMW zu machen,
hält Ihr BMW Händler für Sie bereit.**

Important information!

For your own safety please use only accessory products
released by BMW.
BMW will not guarantee for products of any kind not
released by BMW.

**To turn a BMW
into your very own BMW your BMW dealer
will provide you with a wide range of BMW
accessories.**